

Operator reference	Power	Output torque	Output speed	Volts	Phases	Cycles
F160-CBGB	0.75kw	160Nm	28 rpm	415V	3	50Hz

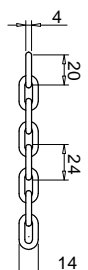

DETAIL OF HALICHAIN
Finish - electro plate

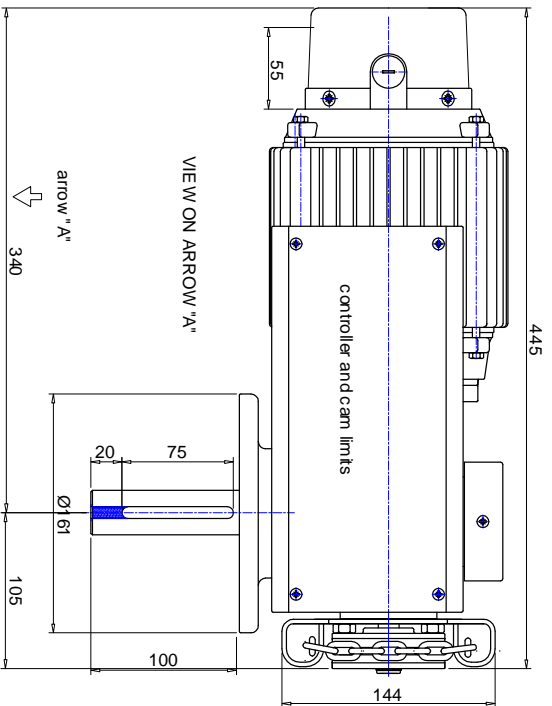
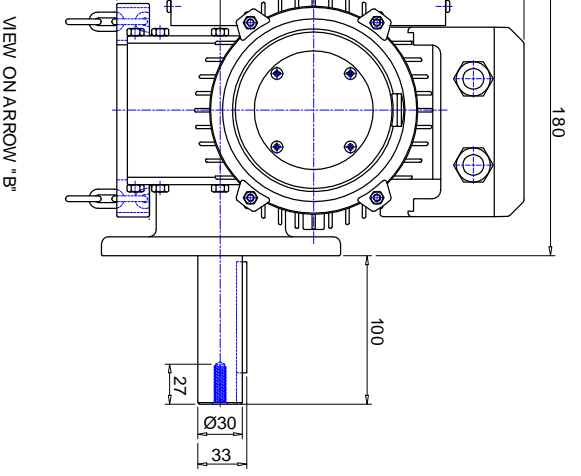
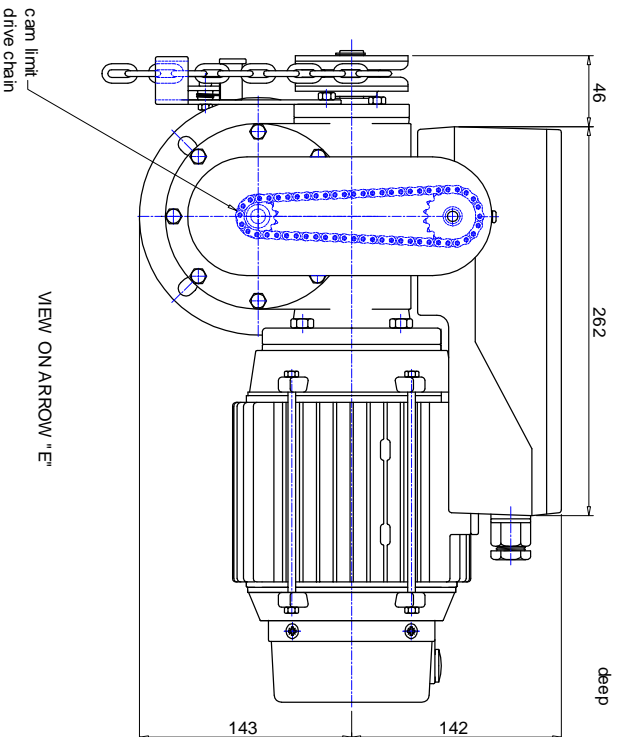
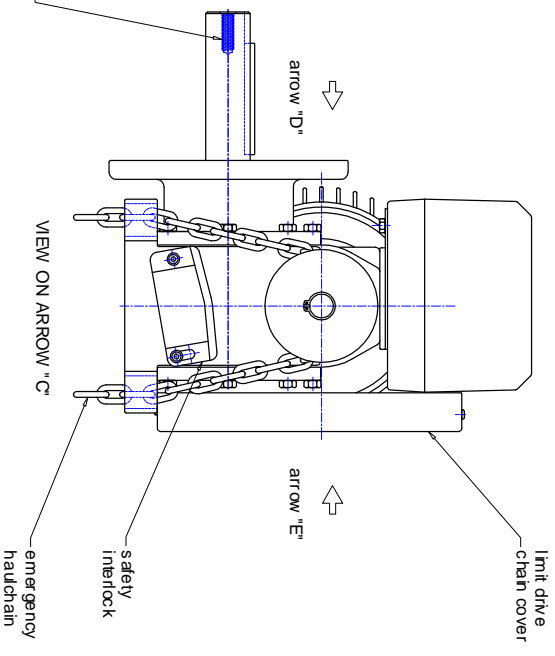
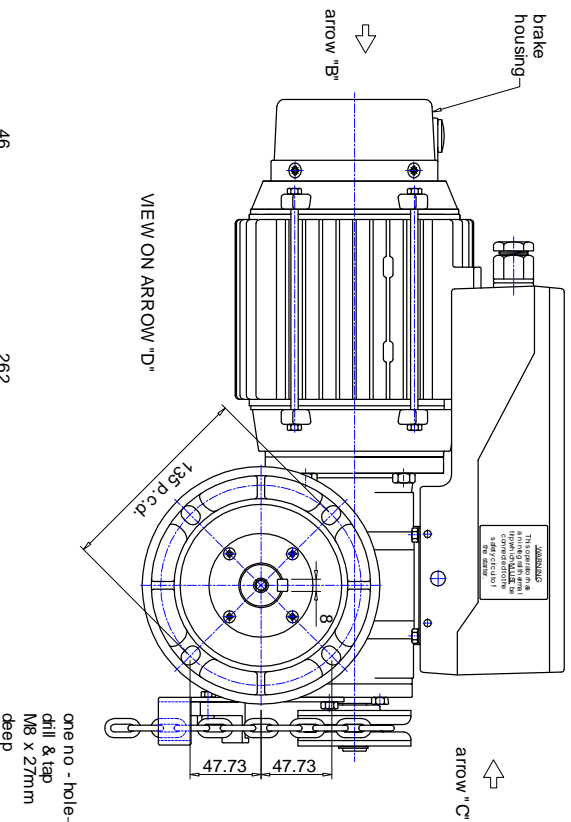

This drawing is the property of Ellard Limited. The drawing may not be reproduced without the written authorisation of Ellard Limited. All intellectual property rights are expressly reserved. Copyright 2007.

ellard
Tel 0161 945 4561
Fax 0161 945 4566
E-mail sales@ellard.co.uk

Dalmore Road
Roundthorn Industrial Estate,
Wythenshawe,
Manchester,
M23 9NX.

Revision

Title

General arrangement of
F160-CBGB flange mounted
rolling shutter door drive
(left hand mount).

Date

15/08/2007

Dwn by

Ron Swift

Chk'd by

C Foster

Dwg #

RS/UF160/0254001