

SPECIFICATION						
Reference	Output torque	Power	Output speed	Voltage	Cycles	Rating
JM1500	368Nm	0.75Kw	15 rpm	415V	50Hz	10mins

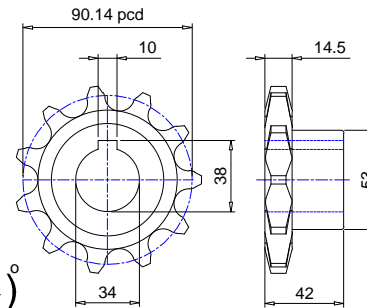
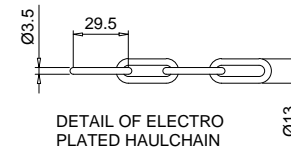
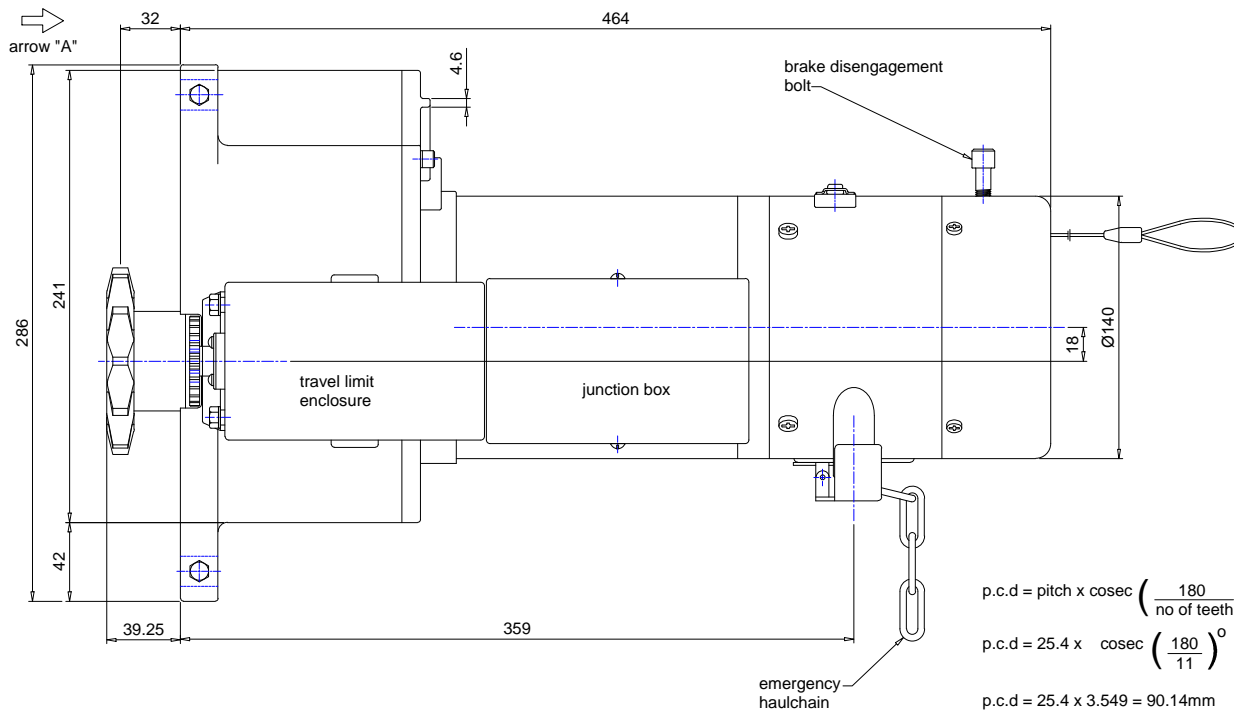
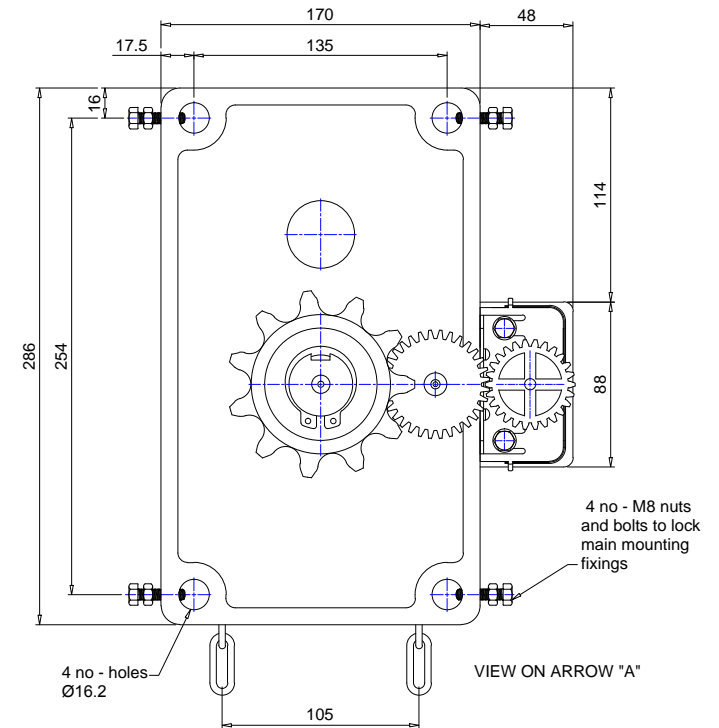

$$p.c.d = \text{pitch} \times \text{cosec} \left(\frac{180}{\text{no of teeth}} \right)^{\circ}$$

$$p.c.d = 25.4 \times \text{cosec} \left(\frac{180}{11} \right)^{\circ}$$

$$p.c.d = 25.4 \times 3.549 = 90.14\text{mm}$$

This drawing is the property of ELLARD LTD, it may not be reproduced without the written authorization of Ellard Limited. All intellectual property rights are expressly reserved

Title
JM1500
GENERAL ARRANGEMENT (1)

Rev/Notes

Date	01/07/2021	
Drawn by	DE	
Chk'd by	AP	
Drg #	JM1500 General Arr (1)	

ELLARD
Roundthorne Industrial Estate
Ellard House, Floats Road
Wythenshawe, Manchester
M23 9WB
Tel: 0161 945 4561, e-mail: technical@ellard.co.uk